

BigStuff GEN4 – CAN EGT - Wiring Diagram

The Bigstuff GEN4 CAN EGT will need to be installed if your ECU did not come equipped with it from the factory. The EGT module uses standard Type-K thermocouples for ease of use. The CAN EGT harness will screw directly into the CAN EGT module.

To configure the software go to the System Section and under the Hardware Configuration and choose CAN EGT. Be sure to choose the Chevy or Ford Engine so that the cylinders temperature sensors line up correctly. For ordering information please contact Bigstuff3.

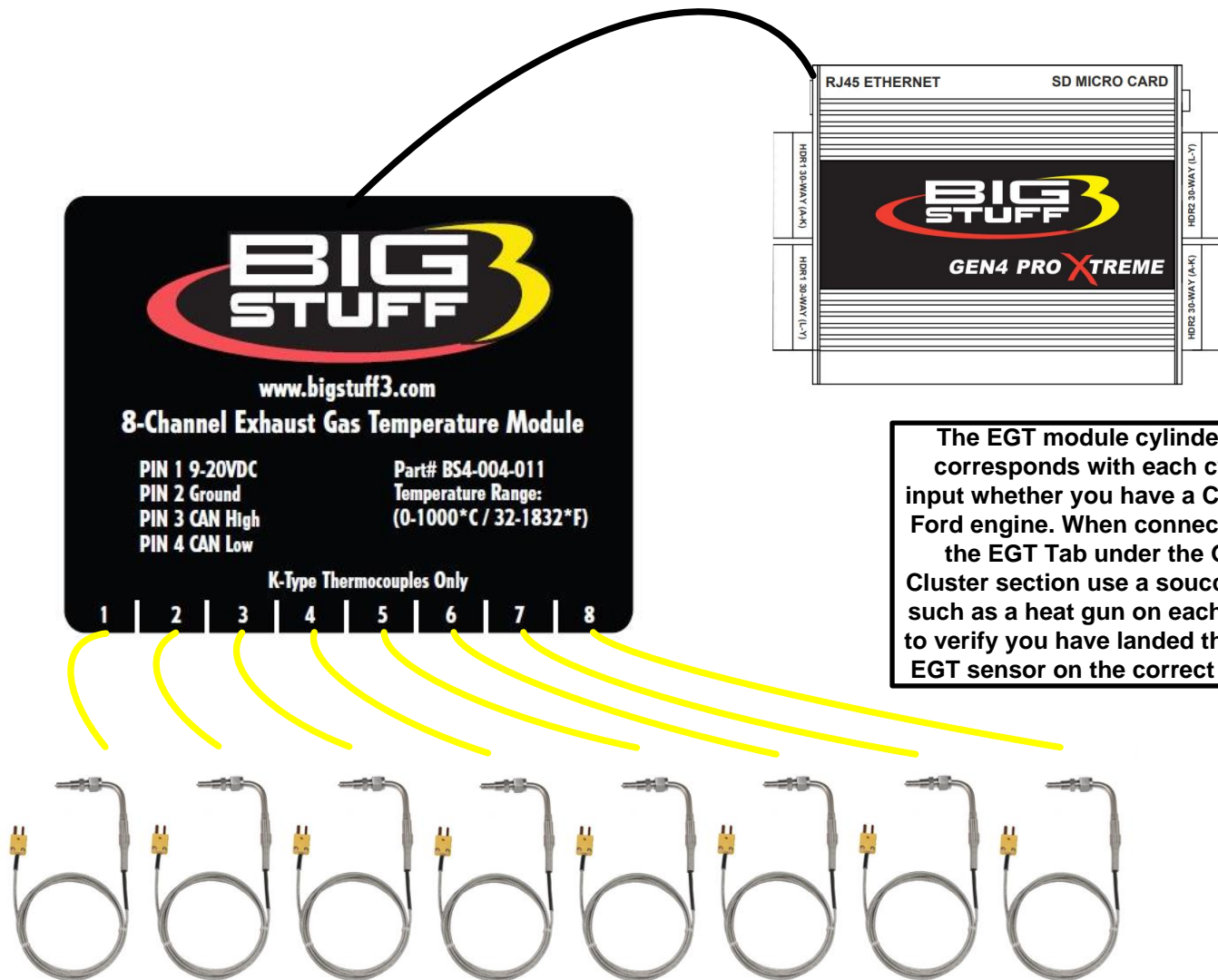

The EGT module cylinder input corresponds with each cylinder input whether you have a Chevy or a Ford engine. When connected go to the EGT Tab under the Gauge Cluster section use a source of heat such as a heat gun on each cylinder to verify you have landed the correct EGT sensor on the correct cylinder.

